



HIH-10~20K-TL

# Three-Phase Hybrid Inverter

10kW / 12kW / 15kW / 20kW

- ✓ Compatible with different batteries, perfect protection function and strong environmental adaptability
- ✓ Wide DC input voltage range design
- ✓ Multi-channel PV MPPT access to improve power generation utilization
- ✓ Off-grid output connection unbalanced load, supports three phase independent output
- ✓ Ingress protection IP65, wall mounted design
- ✓ Battery reverse polarity protection
- ✓ Compatible anti-backflow function
- ✓ Seamless switching between off-grid and on-grid
- ✓ Maximum efficiency up to 98.2%
- ✓ Multiple working mode: Self-use mode, Time-of-use mode, Timing mode, Passive mode
- ✓ Remote monitoring of PC and mobile phones

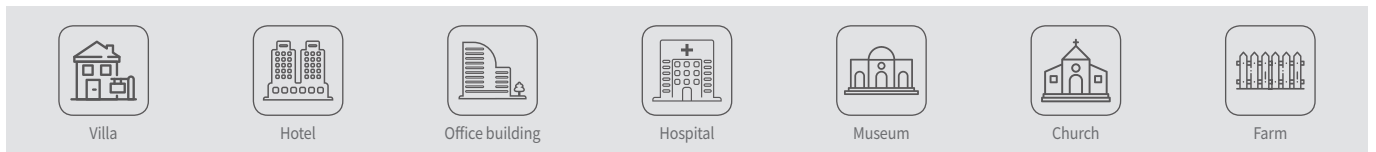
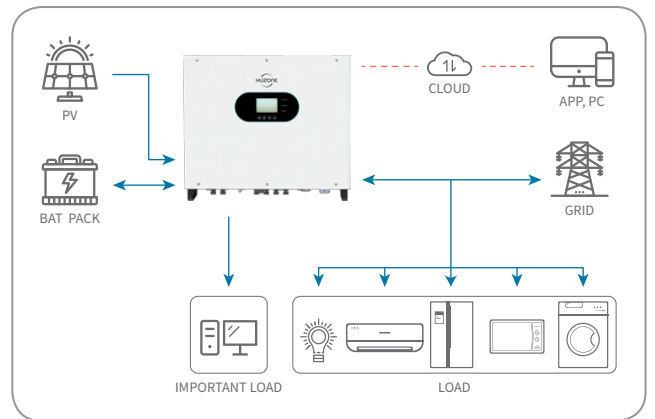

Technical Data HIH-10K-TL HIH-12K-TL HIH-15K-TL HIH-20K-TL

**PV Input**

Maximum Input Power	15 kW	18 kW	22.5 kW	30 kW
Start-up Voltage	200 V			
Maximum Input Voltage	1000 V			
MPPT Voltage Range	180~960 V			
MPPT Working Voltage For Full Load	220~850 V	264~850 V	350~850 V	450~850 V
Number Of MPPT / Strings Per Channel	2/2			
Maximum MPPT Input Current	50 A (25/25)			

**Battery Input**

Battery Type	Lithium, Lead-Acid			
Number Of Battery Input	2			
Voltage Range	180~800 V			
Voltage Range For Full Load	200~800 V	240~800 V	300~800 V	400~800 V
Maximum Charge/Discharge Current	50/50 A (25+25)			
Communication	CAN, RS485			
Battery Charging Strategy	According to BMS instructions / 3 Stages (Lead-Acid)			

**AC Output (On-Grid)**

Rated Output Power	10 kW	12 kW	15 kW	20 kW
Maximum Output Power	11 kVA	13.2 kVA	16.5 kVA	22 kVA
Rated Output Voltage	220/380V, 230/400V (3PH, N, PE)			
Output Voltage Range	184~276 V			
Maximum Output Current	16 A	19 A	24 A	32 A
Output Frequency	50/60 Hz (45~54.9 / 54.9~65)			
Power Factor	1 (0.8 leading~0.8 lagging)			
THDi (Rated Power)	<3%			

**Backup AC Output (EPS)**

Rated Output Power	10 kVA	12 kVA	15 kVA	20 kVA
Maximum Output Power	11kVA 60s, 15kVA 1s	13.2kVA 60s, 18kVA 1s	16.5kVA 60s, 22.5kVA 1s	22kVA 60s, 30kVA 1s
Maximum Output Current	16 A	19 A	24 A	32 A
Rated Output Voltage	220/380V, 230/400V (3PH, N, PE)			
Output Frequency	50/60 Hz ( $\pm 0.2\%$ )			
THDu (Linear Load)	<3%			
Automatic Switching Time	<10 ms			

**General Data**

Maximum Efficiency	98.2%
Protection	DC Lightning Protection, AC Lightning Protection, PV Reverse Polarity Protection, Battery Reverse Protection, Insulation Resistor Detection, Leakage Current Detection, Anti-island Protection, Grounding Fault, Input Overvoltage & Undervoltage, Output Overvoltage & Undervoltage, Input Overcurrent, Output Overcurrent, Overheat Protection
Ingress Protection Rating	IP65
Noise	<40 dB
Temperature Range	-25~60°C
Cooling Method	Smart Fan Cooling
Relative Humidity	0~95%
Altitude	$\leq 4000$ m (>2000 m Derating)
Display	LCD
Communication	RS485 (Standard); Wi-Fi / GPRS / Ethernet (Optional)
BMS Communication	RS485, CAN
Standby Consumption	<15 W
Grid Standard	VDE4105/EN50549
Safety Standard	CE/IEC62109
Weight	37 kg
Dimensions (WxDxH)	591x271x476 mm